

# FINAL Plat of Indian Gap Ranch (West Part)

(NOTE: Approximate patent acreages are shown in parenthesis.)

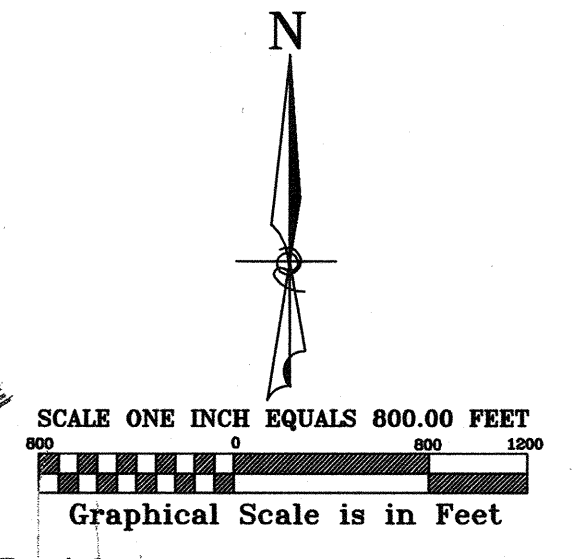

### NOTES:

\* No survey was made to reestablish Patent Survey lines or corners. The Survey Lines shown hereon are approximate. Tracts 6, 7 and 10 each retain 1/3 interest in water well located on Tract 7.

Developer and Tracts 9 and 12 each retain 1/3 interest in water well located on Tract 9.

Topographical information shown is digitized from U.S.G.S. 7.5 minute quadrangle maps.

Road easements shown hereon shall be sixty (60) feet in width, thirty (30) feet either side of centerline, except that the Private road easement between Tract 30 and Tract 32, shall be thirty (30) feet in width, fifteen (15) feet either side of centerline.

All cul-de-sacs shown hereon shall be one hundred twenty (120) feet in diameter, having a radius of sixty (60) feet. No fences, buildings, or other structures shall be erected within an additional twenty-five (25) foot right-of-way "cut-back" from the acute angle of the intersection as shown below.

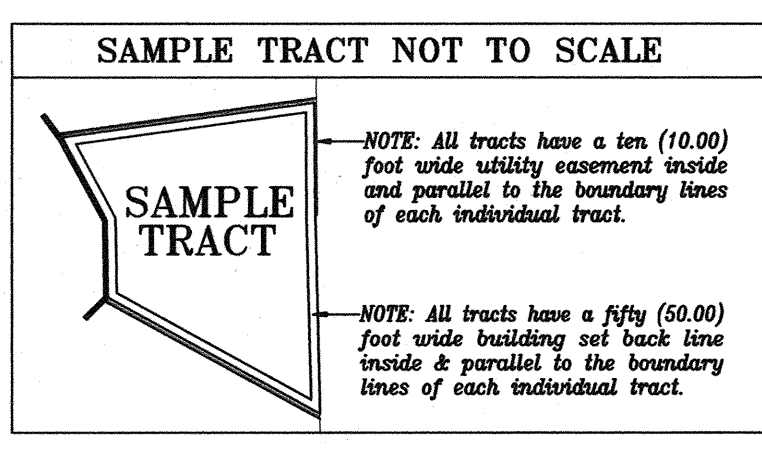
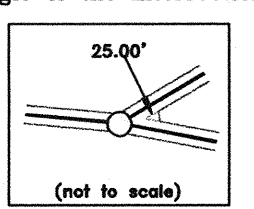

### CURVEDATA

Curve Name	Radius	Length	Delta Angle	Tangent Length	Ch. Length	Ch. Bearing
Curve-1	904.93'	475.18'	30°05'09"	243.20'	469.74'	N51°44'10"E
Curve-2	1195.92'	940.83'	45°04'29"	496.28'	916.76'	N44°09'45"E
Curve-3	2914.79'	178.35'	3°30'21"	89.20'	178.32'	N19°34'41"E
Curve-4	2914.79'	287.84'	5°39'29"	144.04'	287.72'	N14°59'46"E

County Road 650			Caddo Road			Navajo Trail			Lipan Road		
A1	N66°14'58"E	427.71'	C1	N12°15'12"E	453.16'	F1	N10°45'10"W	134.68'	G1	N36°13'47"E	258.94'
A2	N71°40'22"E	739.71'	C2	N12°15'12"E	718.67'	F2	N92°15'06"E	534.70'	G2	N17°58'55"E	307.08'
A3	N69°56'50"E	1217.35'	C3	N82°47'07"E	521.02'	F3	N48°31'37"E	499.39'	G3	N19°43'59"E	299.75'
A4	N69°56'50"E	57.30'	C4	N82°47'07"E	316.99'	F4	N11°50'19"E	205.79'	G4	N15°04'50"E	231.59'
A5	N78°10'51"E	469.79'	C5	N69°46'58"E	392.13'	F5	N86°35'04"E	287.94'	G5	N11°41'34"W	368.21'
A6	N62°28'42"E	206.68'	A38	N70°03'28"E	250.29'	F6	N54°30'58"E	424.83'	G6	N19°03'35"E	140.18'
A7	N85°47'26"E	777.86'	A39	S75°21'16"E	254.96'	F7	N77°44'44"E	117.36'	G7	N20°30'37"W	278.45'
A8	S77°28'18"E	346.00'	A40	N77°16'35"E	744.14'	F8	N23°57'39"E	74.57'	G8	N73°19'19"W	477.86'
A9	S64°20'08"E	389.27'	A41	S75°22'47"E	234.47'	F9	N32°33'14"W	325.21'	G9	N51°37'55"E	133.88'
A10	S64°02'11"E	206.77'	A42	S33°55'57"E	452.16'	F10	N75°04'06"E	154.48'	G10	N20°19'46"E	207.05'
A11	S79°29'57"E	332.76'	A43	S15°55'25"E	384.45'	F11	N18°52'22"E	298.55'	G11	N33°09'27"E	138.26'
A12	S60°30'04"E	348.60'	A44	S33°20'02"E	268.46'	F12	N24°31'20"E	266.95'	G12	N21°14'54"E	274.07'
A13	S75°21'13"E	576.17'	A45	S39°50'22"E	354.77'	F13	N33°40'23"E	310.65'	G13	N22°36'07"W	192.01'
A14	S75°21'13"E	143.60'	A46	S64°11'18"E	272.13'	F14	N32°07'22"E	326.40'	G14	N18°19'42"E	273.47'
A15	N86°59'39"E	424.74'	A47	S64°11'18"E	136.30'	F15	N77°44'44"E	117.36'	G15	N33°56'46"E	201.24'
A16	S84°11'54"E	543.42'	A48	S8°49'08"E	700.85'	F16	N23°57'39"E	74.57'	G16	N45°30'46"E	919.88'
A17	S69°02'02"E	499.24'	A49	S23°38'33"W	235.83'	F17	N77°44'44"E	117.36'	G17	N19°32'52"E	253.69'
A18	S83°10'21"E	652.82'	A50	S23°38'33"W	419.1'	F18	N23°57'39"E	74.57'	G18	N10°27'10"W	493.93'
A19	S64°37'19"E	432.20'	A51	S11°22'26"W	400.21'	F19	N23°57'39"E	74.57'	G19	N20°27'28"W	395.18'
A20	S82°34'49"E	363.21'	A52	S11°22'26"W	520.78'	F20	N23°57'39"E	74.57'	G20	N19°16'36"E	277.12'
A21	S56°08'37"E	398.83'	A53	S16°01'02"E	248.20'	F21	N10°45'10"W	134.68'	G21	N47°07'47"W	294.91'
A22	S31°02'30"E	353.24'	B1	S10°03'44"W	96.54'	F22	N47°26'24"E	304.84'	G22	N72°24'08"W	241.89'
A23	S44°32'56"E	250.16'	B2	S42°32'41"W	167.49'	F23	S75°29'27"E	138.34'	G23	N73°24'08"W	343.61'
A24	S23°16'53"E	405.47'	B3	S51°24'06"W	1320.13'	F24	S75°29'27"E	138.34'	G24	N22°20'47"W	402.12'
A25	S44°55'47"E	159.07'	B4	S20°58'30"W	118.12'	F25	S75°29'27"E	138.34'	G25	N33°19'23"W	273.30'
A26	S44°55'47"E	176.52'	B5	S17°28'44"E	115.168'	F26	S75°29'27"E	138.34'	G26	N22°20'47"W	131.64'
A27	S64°28'30"E	277.24'	B6	S17°28'44"E	87.03'	F27	S75°29'27"E	138.34'	G27	N11°57'29"W	543.21'
A28	S82°09'50"E	379.28'	B7	S17°28'44"E	386.22'	F28	S75°29'27"E	138.34'	G28	N19°54'54"E	141.36'
A29	N56°18'54"E	182.28'	B8	S22°14'08"W	178.30'	F29	S75°29'27"E	138.34'	G29	N22°20'47"W	117.67'
A30	N22°52'29"E	146.96'	B9	S37°55'10"W	266.04'	F30	S10°57'57"W	249.63'	G30	N19°54'54"E	141.36'
A31	N44°31'38"E	374.02'	B10	S58°39'29"W	221.79'	F31	S36°03'17"W	154.87'	G31	N14°40'25"E	129.10'
A32	N24°21'47"E	103.63'	B11	S20°56'25"E	100.88'	F32	S67°09'02"W	174.89'	G32	N18°54'01"W	344.01'
			B12	S20°56'25"E	100.88'	F33	S63°53'21"W	297.34'	G33	N32°35'27"W	114.95'
			B13	S44°51'22"W	307.65'	F34	S71°58'42"E	312.11'			
			B14	S55°39'20"W	257.34'	F35	N11°53'26"E	314.47'			
			B15	S35°34'23"W	185.78'	F36	N89°12'18"E	208.81'			
			B16	S27°12'02"W	165.20'	F37	S29°11'34"E	240.89'			
			B17	S67°29'09"W	133.34'	F38	N42°13'7"E	141.20'			
			B18	N32°58'04"W	239.85'	F39	N85°44'02"E	295.97'			
			B19	N89°17'54"W	408.04'	F40	S79°58'12"E	99.75'			
			B20	S64°24'58"W	255.71'	F41	S82°28'01"E	234.07'			
			B21	S74°20'10"W	665.72'	F42	S75°45'01"E	245.53'			
			B22	S69°37'14"W	458.96'	F43	S79°58'12"E	99.75'			
			B23	S69°37'14"W	458.96'	F44	S82°28'01"E	234.07'			
			B24	S69°37'14"W	458.96'	F45	S82°28'01"E	234.07'			

Pawnee Trail			Tonkawa Trail			Kinikinnick Road		
H1	S75°18'08"W	84.89'	J1	N75°17'22"E	254.37'	K1	S71°05'58"E	101.67'
H2	S25°32'26"W	259.25'	J2	N47°26'24"E	304.84'	K2	S68°15'14"E	335.05'
H3	S45°25'41"W	267.44'	J3	N78°56'30"E	209.73'	K3	N89°25'46"E	550.19'
H4	S88°36'11"W	336.18'	J4	N43°30'57"E	344.94'	K4	S76°47'19"E	233.92'
H5	S67°46'25"W	205.16'	J5	N60°32'00"E	284.31'	K5	S28°55'19"E	487.17'
H6	S50°01'54"W	153.67'	J6	N67°14'55"E	443.32'	K6	S33°39'58"E	339.52'
H7	S85°43'16"W	137.91'	J7	S88°27'25"E	420.46'	K7	S26°35'25"E	222.25'
H8	S64°49'31"W	204.81'	J8	N76°41'43"E	157.94'	K8	S69°12'18"E	208.81'
H9	S87°49'57"E	120.65'	J9	S75°29'27"E	138.34'	K9	S29°11'34"E	240.89'
H10	S65°26'25"W	474.03'	J10	N79°49'50"E	159.66'	K10	S86°33'54"E	359.83'
H11	S83°30'06"W	396.47'	J11	S75°38'42"E	312.11'			
H12	N86°02'10"E	142.89'	J12	N65°59'44"E	429.50'			
H13	S47°59'44"W	386.69'	J13	N51°01'14"E	180.88'			
H14	S84°01'28"W	343.03'	J14	N55°04'16"E	207.57'			
H15	S43°50'20"W	317.91'	J15	N11°53'26"E	314.47'			
H16	S35°34'23"W	185.78'	J16	N59°24'31"E	85.70'			
H17	S27°12'02"W	165.20'	J17	S50°09'10"E	257.34'			
H18	S67°29'09"W	133.34'	J18	N85°16'41"E	211.04'			
H19	N32°58'04"W	239.85'	J19	N36°06'44"E	169.13'			
H20	N89°17'54"W	408.04'	J20	N85°30'24"E	120.24'			
H21	S64°24'58"W	255.71'	J21	N43°52'22"E	431.94'			
H22	S74°20'10"W	665.72'	J22	N18°03'46"E	431.11'			
H23	S69°37'14"W	458.96'	J23	N03°41'02"E	482.31'			
H24	S69°37'14"W	458.96'	J24	N42°41'37"W	146.76'			
			J25	N8°52'28"E	301.68'			

Iron stake found in recognized common corner between Survey 18, 11, 24, and S. P. 80 1/2.

LAND SURVEYING & MAPPING ~ P.O. BOX 1593 ~ MEDINA, TEXAS 78055 ~ 830-460-4900

**LEGEND**

- Found Iron Stake
- Large Nail Found
- Fence Post
- Set 1/2" diameter iron stake with a cap marked "4394"
- Overhead utility line
- Fence
- Patent Survey Line
- ⊕ Water Well

BASIS OF BEARINGS was derived from True North observations using G.P.S. (Trimble 4400 and 5700) R.T.K. systems October 14, 2004 through January 5, 2007.